

Monolithic discriminator dual QD10.7-2800/01



Application

- 2 pol resonator
- discriminator
- use in mobile and stationary transceivers

Limiting values		Unit	Value
Center frequency	f_0	MHz	10.7
Peak separation		kHz	± 14
Sym. resonance frequency	f_s at 25°C	MHz	10.686 ± 400 Hz
Asym. resonance frequency	f_a at 25°C	MHz	10.714 ± 850 Hz
Change of sy. resonance frequency	-40...+80°C	ppm	< 30
Dynamical capacity		fF	ca. 5.4
Terminating impedance Z		Test circuit	
R1 C1		Ohm/pF	12.5
R2 C2		Ohm/pF	12.5
Operating temp. range		° C	-40...+80

Characteristics QD10.7-2800/01

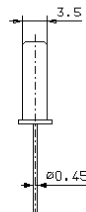
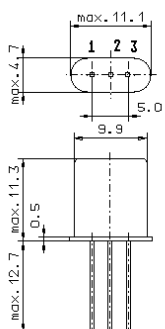
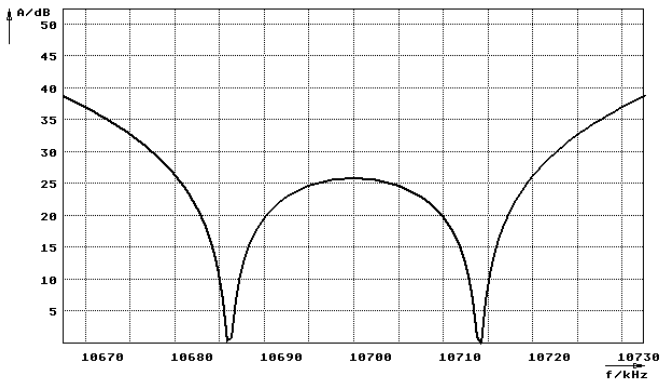

GH3

Application circuits

